

metos

CITRUS JUICER HAMILTON BEACH

HCJ967R



Installation and Operation Manual

Juicer Safety

IMPORTANT: This operation manual should be reviewed with all equipment operators as part of your operator training program.

Your safety and the safety of others is very important.

We have provided many important safety messages in this manual and on your appliance. Always read and obey all safety messages.



This is the safety alert symbol.

This symbol alerts you to hazards that can kill or hurt you and others.

All safety messages will be preceded by the safety alert symbol and the word “DANGER” or “WARNING.” These words mean:

⚠ DANGER

You will be killed or seriously injured if you don't follow instructions.

⚠ WARNING

You can be killed or seriously injured if you don't follow instructions.

All safety messages will identify the hazard, tell you how to reduce the chance of injury, and tell you what can happen if the instructions are not followed.

⚠ WARNING



Electrical Shock Hazard

Plug into a grounded outlet.

Do not remove ground.

Do not use an adapter.

Do not use an extension cord.

Disconnect power before cleaning.

Failure to follow these instructions can result in death, fire, or electrical shock.

For Commercial Use Only

Juicer Safety

IMPORTANT SAFETY INSTRUCTIONS

WARNING – When using electrical appliances, basic safety precautions should always be followed to reduce the risk of fire, electric shock, and/or injury to persons, including the following:

1. Read all instructions.
2. This appliance is not intended for use by persons with reduced physical, sensory, or mental capabilities, or lack of experience and knowledge, unless they are closely supervised and instructed concerning use of the appliance by a person responsible for their safety.
3. Close supervision is necessary when any appliance is used near children. Children should be supervised to ensure that they do not operate or play with the appliance.
4. To reduce risk of personal injury, unplug cord from outlet when not in use, and before putting on or taking off parts or doing any other servicing of the juicer.
5. Plug into a grounded outlet.
6. Do not use an adapter.
7. Do not use an extension cord.
8. Do not let cord hang over edge of table or counter or touch hot surfaces.
9. Do not place on or near a hot gas or electric burner, or in a heated oven.
10. To protect against electric shock, do not immerse cords, plugs, or the juicer base in water or any other liquid.
11. Do not use appliance for other than intended use.
12. Avoid contacting moving parts.
13. Do not store any kitchen utensils in the bowl. The juicer would be damaged if inadvertently turned on.
14. Inspect reamer daily. Check for cracks, nicks, or broken ribs.
15. Do not use outdoors.
16. Do not place in or near water or liquids.
17. To reduce risk of personal injury and to prevent damage to the juicer, do not insert utensils into the reamer while operating the juicer.
18. The use of accessory attachments not recommended by Hamilton Beach may cause injuries.
19. To prevent damage, DO NOT move or shake the juicer while in operation. If juicer action stops during operation, turn juicer OFF/O and reset unit.
20. Do not spray the base with a high-pressure spray gun.
21. Disconnect power before cleaning or servicing.
22. Do not operate any appliance with a damaged cord or plug after the appliance malfunctions, or is dropped or damaged in any manner. Appliance must be serviced by the manufacturer, its service agent, or similar qualified persons in order to avoid a hazard.
23. **CAUTION!** In order to avoid a hazard due to inadvertent resetting of the thermal cut-out, this appliance must not be supplied through an external switching device, such as a timer, or connected to a circuit that is regularly switched on and off by the utility.

– SAVE THESE INSTRUCTIONS –

Sanitizing

Sanitize appliance daily after each use. The sanitizing solution should consist of 1 Tablespoon (15 ml) of bleach per 1 gallon (3.8 liters) of clean, cool water (60°F/16°C) mixed according to the instructions on the bleach container.

1. Immerse splash cover, reamers, strainer, rubber collar, and bowl in sanitizing solution for 2 minutes.
2. Allow to air dry. When ready to use, rinse with clean water.
3. Wipe exterior with soft cloth dampened with sanitizing solution.

Parts and Features

NOTE: Before first use, disassemble and wash according to instructions under "Cleaning the Juicer."

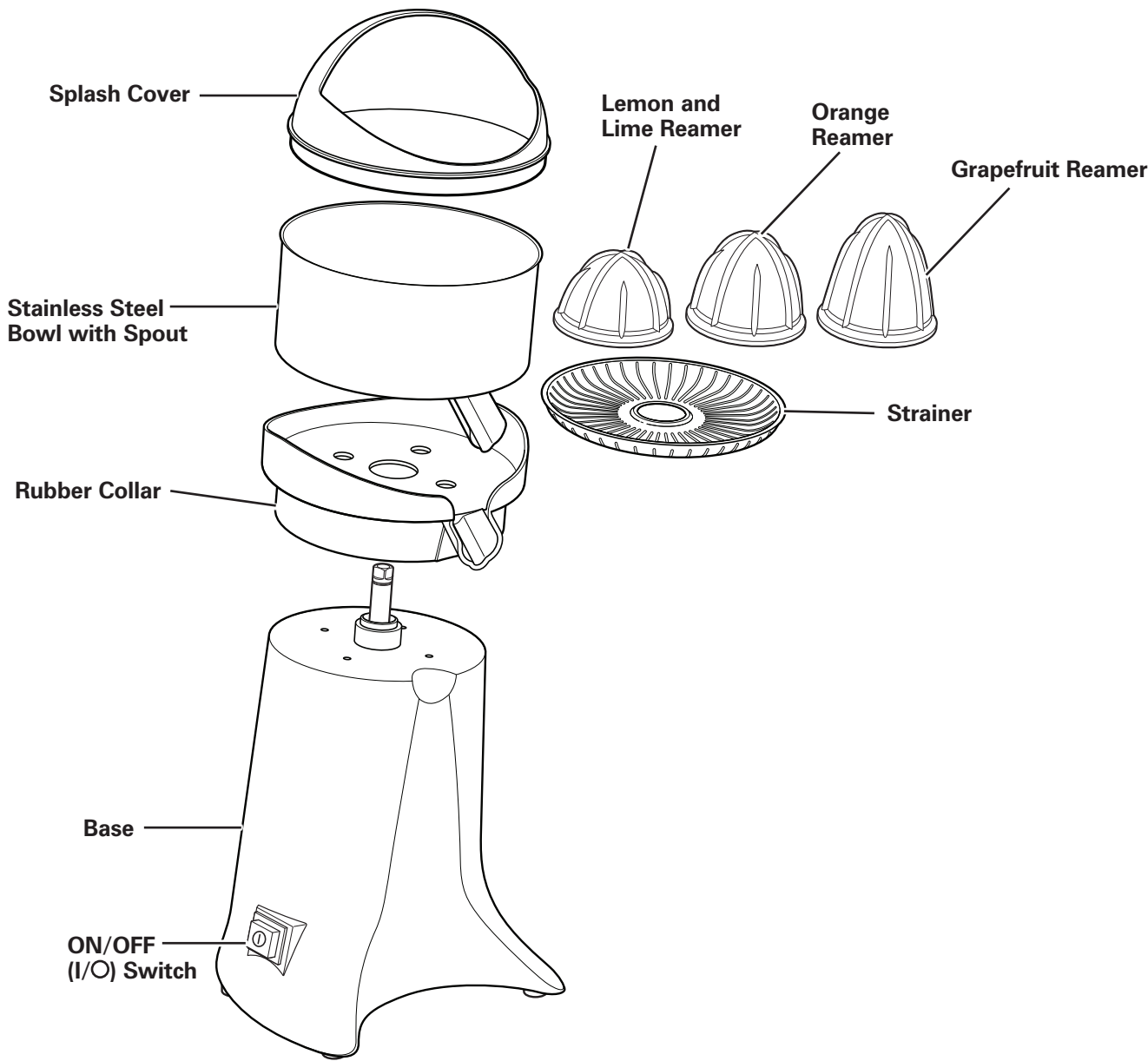

Operating the Juicer

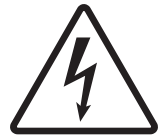

1. Place rubber collar and bowl on base over motor shaft.
2. Insert strainer into bowl.
3. Select reamer and push onto motor shaft.
4. Place splash cover on bowl.
5. Plug into grounded electrical outlet.
6. Press power switch to ON (I).
7. Place halved citrus fruit on reamer and hold citrus in place until all the juice is removed.

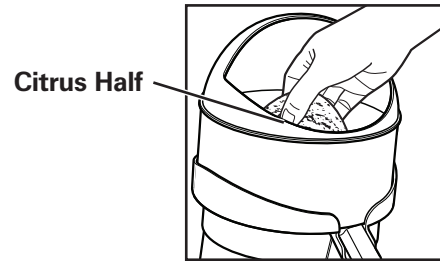

NOTES:

- When placing the fruit onto the reamer, make sure your hand touches only the fruit and does not come in contact with the reamer.
 - For best juicing, citrus fruits should be at room temperature.
8. When finished juicing, press power switch to OFF (O).

Cleaning the Juicer



1. Unplug the juicer.
2. Remove the splash cover, reamer, strainer, bowl, and rubber collar.
3. Remove all pulp and seeds from all parts.
4. Wash all removed parts in a commercial dishwasher or hand wash using warm soapy water. Rinse and dry.
5. Wipe the base and motor shaft with a clean, damp, soft cloth and dry.

NOTES:

- Do not immerse the base in water.
- Do not allow juice to dry on juicer parts.
- Remove pulp and seeds from parts in between uses.

Troubleshooting Guide

Problem . . .	Solution . . .
Juice will not flow through container spout.	<ul style="list-style-type: none"> • Check to see if the strainer or spout is plugged with seeds or pulp from the last use.
Juicer will not ream fruit.	<ul style="list-style-type: none"> • Make sure enough pressure is applied to the fruit during operation. • Make sure the reamer is pushed all the way down onto the motor shaft.
Motor will not run.	<ul style="list-style-type: none"> • Motor has stalled and/or motor cutout switch has opened. Unplug the juicer and allow the unit to cool. • Make sure excessive pressure is not applied to fruit during operation. • Make sure juicer is plugged into outlet and power switch is in the ON (I) position.
Juice has bitter taste.	<ul style="list-style-type: none"> • Make sure excessive pressure is not applied to fruit during operation. • Too much pressure will allow rind in juice, which is bitter.

Metos Oy Ab

Ahjonkaarre, 04220 Kerava

Puh. 0204 3913

metos.finland@metos.fi

www.metos.fi

metos
kitchen intelligence®