

metos

HEIGHT ADJUSTABLE TABLE

TYPE: ATE600-ATE2300

Installation and Operation Manual



S/N: 2004T40S200010

Valid from: 10. 05. 2004

Rev.: 2.0

4136100, 4136101, 4136102, 4136103, 4136104, 4136105, 4136106, 4136107, 4136108,
4136109, 4136110, 4136111, 4136112, 4136113, 4136114, 4136115, 4316116, 4316117

Dear Customer,

Congratulations on deciding to choose a Metos appliance for your kitchen activities. You made an excellent choice. We will do our best to make you a satisfied Metos customer like thousands of customers we have around the world.

Please read this manual carefully. You will learn correct, safe and efficient working methods in order to get the best possible benefit from the appliance. The instructions and hints in this manual will give you a quick and easy start, and you will soon note how nice it is to use the Metos equipment.

All rights are reserved for technical changes.

You will find the main technical data on the rating plate fixed to the equipment. When you need service or technical help, please let us know the serial number shown on the rating plate. This will make it easier to provide you with correct service.

For your convenience, space is provided below for you to record your local Metos service contact information.

METOS TEAM

Metos service phone number:.....

Contact person:.....

1. General	1
1.1 Symbols used in the manual	1
1.2 Symbols used on the appliance	1
1.3 Checking the relationship of the appliance and the manual	1
2. Safety	2
2.1 Safe use of the appliance	2
3. Functional description	3
3.1 Intended use of the appliance	3
3.2 Construction and functional description	3
4. Operating instructions	4
4.1 Before use	4
4.2 Operation	4
4.3 After use	4
4.3.1 Cleaning	4
5. Installation	5
6. Technical specifications	7

1. General

Carefully read the instructions in this manual as they contain important information regarding proper, efficient and safe installation, use and maintenance of the appliance.

Keep this manual in a safe place for eventual use by other operators of the appliance.

The installation of this appliance must be carried out in accordance with the manufacturer's instructions and following local regulations. The connection of the appliance to the electric and water supply must be carried out by qualified persons only.

Persons using this appliance should be specifically trained in its operation.

Switch off the appliance in case of failure or malfunction. The periodical function checks requested in the manual must be carried out according to the instructions. Have the appliance serviced by a technically qualified person authorized by the manufacturer and using original spare parts.

Not complying with the above may put the safety of the appliance in danger.

1.1 Symbols used in the manual



This symbol informs about a situation where a safety risk might be at hand. Given instructions are mandatory in order to prevent injury.



This symbol informs about the right way to perform in order to prevent bad results, appliance damage or hazardous situations.



This symbol informs about recommendations and hints that help to get the best performance out of the appliance.

1.2 Symbols used on the appliance



This symbol on a part informs about electrical terminals behind the part. The removal of the part must be carried out by qualified persons only.

1.3 Checking the relationship of the appliance and the manual

The rating plate of the appliance indicates the serial number of the appliance. If the manuals are missing, it is possible to order new ones from the manufacturer or the local representative. When ordering new manuals it is essential to quote the serial number shown on the rating plate.

2. Safety

2.1 Safe use of the appliance



For safe use of the appliance, observe the following safety instructions:

- When moving or servicing the appliance, always unplug it from the power supply.
- While cleaning the appliance, be cautious not to allow the electrical devices to come into contact with water. It is not allowed to use a jet of water for washing the appliance.
- Exposing the appliance to the rain is forbidden.



The maximum time of operation is 6 minutes per hour and the maximum allowable load is 200 kg.

When lowering the table take care that no objects can get squeezed.

3. Functional description

3.1 Intended use of the appliance

The appliance is intended for providing an ergonomic working position with the help of height adjustment. The working height can be adjusted between 70 and 90 cm.

The appliance can be safely used as a stand for heavy kitchen appliances, such as slicing machines and vegetable slicers.

Drawers and cupboards can be installed in the body below the worktop, considering the maximum allowable load.

The shelf, drawers and cupboards move along with the table, keeping the distance between the worktop and shelf standard. This makes it possible to use the shelf for storing objects.

The appliance is suitable for use in professional kitchens, bakeries etc.

3.2 Construction and functional description

The worktop and body are made of stainless steel.

Height adjustment takes place with the help of electric motors. The operating switch is located on the right, in the holder under the front edge of the table top. The operating switch can be removed from its holder.

4. Operating instructions

4.1 Before use

Make sure before taking the appliance into use that it has not suffered damage during transportation that would prevent safe operation.

4.2 Operation

Adjust the height by pressing the membrane switch of the operating switch. The operating switch is located on the right, in the holder under the front edge of the table top. The operating switch can be removed from its holder.

LEFT - UP

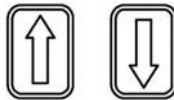

RIGHT - DOWN



The maximum time of operation is 6 minutes per hour and the max. allowable load is 200 kg.

When lowering the table take care that there are no obstacles preventing the movement.

4.3 After use

4.3.1 Cleaning



It is not allowed to use a jet of water for washing the table.

For daily and weekly cleaning, wipe the table with a damp cloth using a detergent suitable for stainless steel.

Shelf elements can be detached and washed in a dishwasher.

5. Installation



The lifting area in the installation place must be free from obstacles, such as radiator pipes, window sills, sockets etc.

Adjust the table in a horizontal position by using the screws on the legs. Check that the table rests firmly on all the four legs.

Plug the electrical cable in an approved socket. It is not allowed to use an extension cord.

6. Technical specifications

Connection diagram 42-456-92

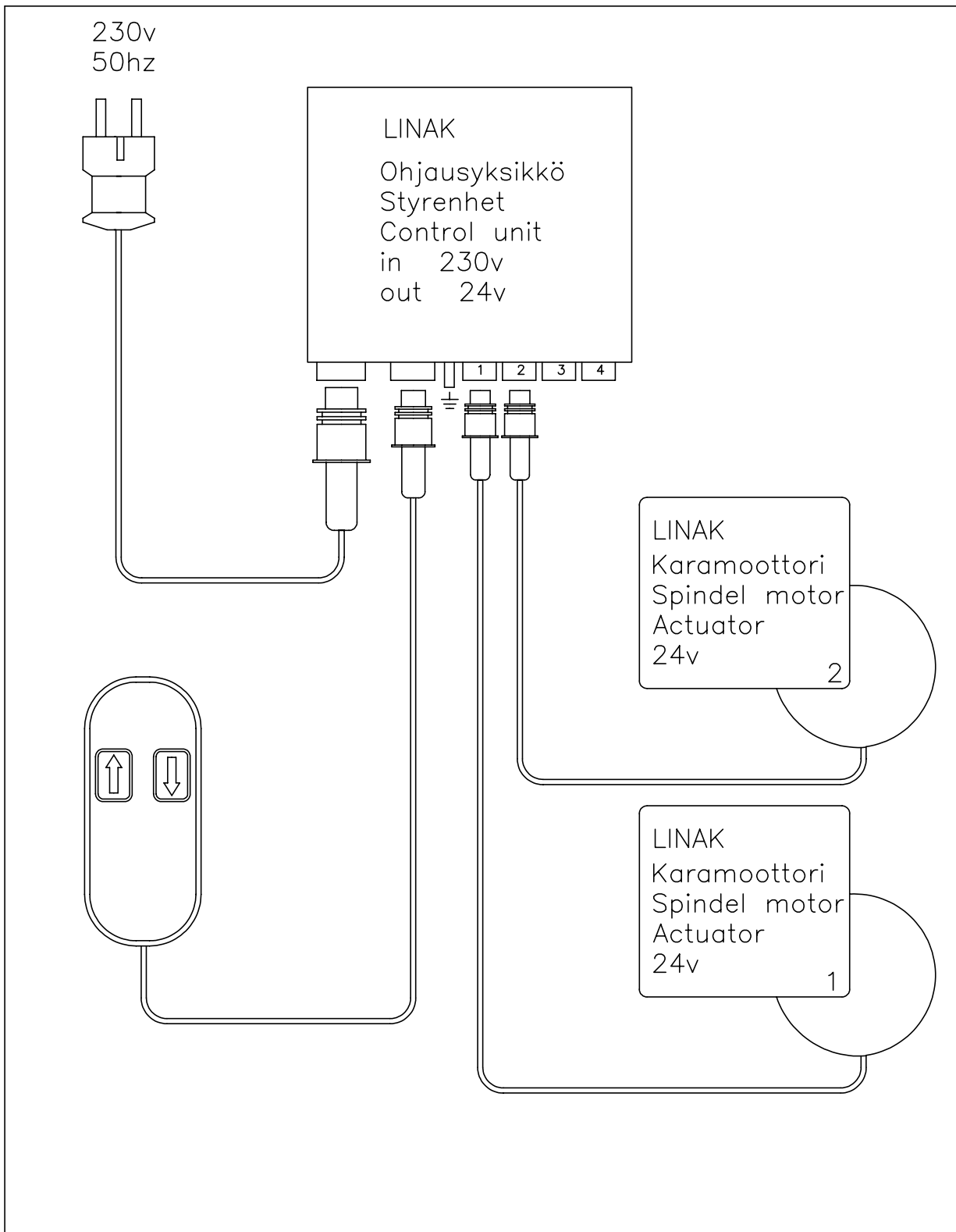

Kpl	Piir. no	Osa	Aine	Nimi, mitat, malli			Huomautuksia						
Kpl	Kok.piir.	Osa	Pinta PINTA	Paino P _____ L _____	Suhde	Piirt. Suunn.	AP	27.2.04					
Kpl/työn.	Työnumero		Nimi KYTKENTÄKAAVIO			Tark.							
						Ent.no							
						Kopliplingsschema/Connection diagram ATE0600-ATE2300						Uusi no	
						Korkeus-säätöpöytä/ Hög-och sänkbar bänk/ Height adjustable table						42-456-92	

V:\users\metos\kuvat3\nostop\malli03\kytkkaav

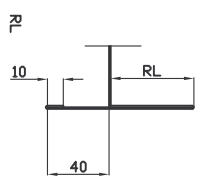
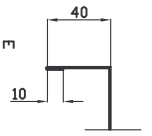
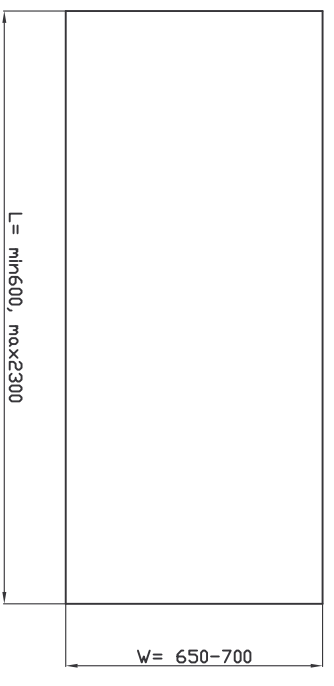
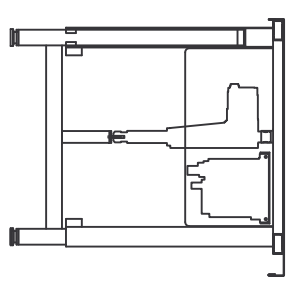
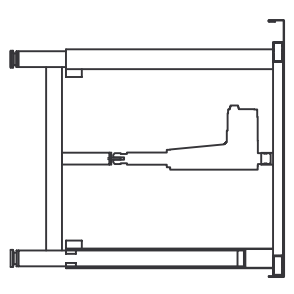
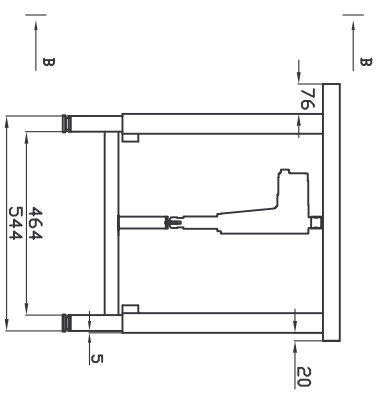
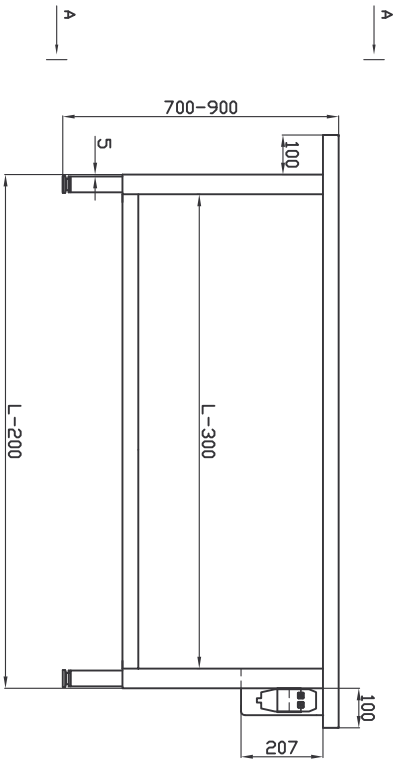

Kpl	Piir. no	Osa	Aihe	Nimi, mitat, malli	Suhde	Piirt. Suunn.	Huomautuksia
Kpl	Kok.nro		Pinta	Paino	1:10		OPT 3,10,05
Kpl/yht.	Työnumero			L 41		Tark.	
			Nimi	ATE		Hv.	
			Adjustable table,electric			Enk.no	
			Pöytäkoopp. - nimi			Uusi no	
			matos				
			KALUSTEHDAS				
			SORSAKOSKI				

Technical specifications

Item	Specification
Dimensions WxD	600-2300 x 650 mm
Adjustment range	700-900 mm
Legs	40 mm square tube
Adjustment of legs	20 mm
Material	Stainless steel
Electric motor	230/24 V
Max. load	200 kg

ATE600-ATE2300

Päiväys / Datum / Date 16.03.2004

Me / Vi / We

Valmistajan nimi / Tillverkarens namn / Manufacturer's name

HACKMAN METOS OY AB, KALUSTETEHIDAS

Osoite / Adress / Address

79130 SORSAKOSKI
FINLAND

vakuutamme yksinomaan omalla vastuullamme, että seuraava tuote:
försäkrar helt på eget ansvar att följande produkt:
declare under our sole responsibility that the product:

Nimi, tyyppi tai malli / Namn, typ eller modell / Name, type or model

Metos korkeussäätöpöytä ATE 600-2300
Metos höj- och sänkbar bänk ATE 600-2300
Metos height adjustable Table ATE 600-2300

johon tämä vakuutus liittyy, on (mikäli asiankuuluvaa) seuraavan standardin (seuraavien standardien) tai muun normatiivisen asiakirjan (muiden normatiivisten asiakirjojen) vaatimusten mukainen
till vilken denna försäkran hör, uppfyller (vid behov) kraven i följande standard (standarder) eller annat (andra) normativa dokument
to which this declaration relates is in conformity with (if necessary) the following standard(s) or other normative document(s)

Tunnus, vuosiluku tai julkaisupäivä / Beteckning, årtal eller publiceringsdatum / Designation or number, year or date of issue

EN-SFS 292-1;1991 ja /och / and EN-SFS 292-2;1991
EN-SFS 60204-1;1993 soveltuvin osin / tillämpliga delar / applicable parts
EN-SFS 60445-1;1990 ja / och / and EN 60335-2-50;1989
EN-SFS 50081-1;1992
EN-SFS 50082-2;1995

ja noudattaa (mikäli asiankuuluvaa) seuraavan direktiivin (seuraavien direktiivien) määräyksiä
och följer (vid krav) följande direktivs bestämmelser
and in conformity with (if necessary) orders of following directive(s)

MSD 89/392/EEC sekä lisäykset / och tilläggen / and additions 92/31 ja / och / and 93/68
LVD 73/23 ja lisäys / och tillägget / and addition 93/68
EMC 89/336/EEC sekä lisäykset / och tilläggen / and additions 92/31 ja / och / and 93/68

Vakuutuksen antopaikka ja päivä / Utfärdad på ort och datum / Place and date of issue

SORSAKOSKI 16.03. 2004

Valtuutetun henkilön nimi, nimikirjoitus ja asema / Bemyndigad persons namn, namnteckning och befattning / Name, signature and title of authorized person



Ilpo Piironen
Paikallispäällikkö / Plant Manager



Tuomo Räisänen
Sunnittelupäällikkö / Desing Manager